

# SX NANO

User manual

Additional languages at:  
www.yihisxmini.com

Thank you for choosing the SX NANO YiHi's ALL-IN-ONE device, which uses the new YiHi ESS driver technology.

This device utilizes a pump to pull/draw liquid to/from the atomizer.

### Reference Diagram

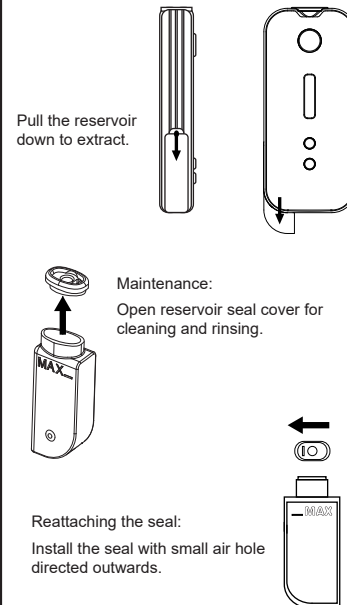
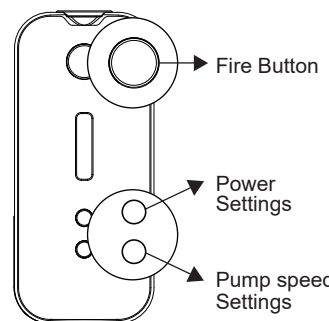

### E-Liquid Filling Method

1. Pull down the liquid reservoir.
2. Fill E-Liquid through the cap's bigger hole.
3. Reinsert the reservoir.

### Operation Guide:

- Turn On** -Press fire button X 5 times
- Lock** -Press fire button X 3 times
- Unlock** -Press fire button X 3 times

### First Use Instructions

1. Fill the Eliquid reservoir.
2. Install the ADA V2 atomizer.
3. Press the fire button once to begin an automated Eliquid feeding phase. the screen will state: "No Liquid"
4. Once the pump stopped, the device will enter a short analyzing & priming state awaiting coil saturation (fire button will be cut off during priming).

The device is now ready to vape.

Press up to choose a power preset. Each power preset has its own default adjustable pump speed memory. Press down to tweak and find your preferred feeding speed.

\*Press up to abort auto feeding if needed

### Main Screen Operation:



ADA mode only supports:

0.6Ω SS316L ADAv2 Coil

Check future updates for additional supported coils.

RSA deck not supported – Check future updates.

Press "Up" once to enter power presets: COOL | NORMAL | WARM



Scroll presets with "Up" & "Down" buttons. Press Fire button to confirm.

Press "Down" once to enter pump settings:



Adjust the pump speed with the Up &Down buttons, press fire button to confirm.

Note: Each preset has its own pump speed memory slot.

### Manual Pump / Draw E-Liquid

To manually pump up liquid - Long press the "Up" button.

To manually draw excess liquid - Long press the "Down" button.

### Factory default pump speeds :

0.6Ω SS316 ADAv2 Coil

COOL	NORMAL	WARM
30	40	45

Explore and find the best speed settings for your E-Liquids. 50/50 PG/VG might require a lower pump speed.

The higher the power, the higher the E-liquid speed required.

warning, use lower power for ultra sweet liquids due to higher sugar residue

### Configuration Menu:

Press the fire button 5 times to enter the configuration menu.

**SHUTDOWN** **UPDATE** **EXIT** **HELP** **BRIGHTNESS**

Operation:

Press Up/Down buttons to navigate.

Press the fire button to confirm.

- SHUTDOWN** : Shut down device
- UPDATE** : Upgrade the firmware
- EXIT** : Back to the main interface
- HELP** : Usage information
- BRIGHTNESS** : Brightness control

General coil tip:  
Fresh coils might need a few puffs to break-in.

### Upgrade Instructions:

1. SX Nano device - Enter the menu -> Update (Press "Fire" button to initiate)
2. Connect the device to the computer via USB cable
3. Open the SXi software on PC, select software upgrade and choose the necessary firmware file. (www.yihisxmini.com -> Support -> Download Center)
4. Click on the "Upgrade" button in SXi PC Software
5. Once the upgrade process is done, unplug the USB cable. The device is now ready for use.

### Upgrade Instructions (video):

Scan the QR Code For an Upgrade Guide on YouTube



### Upgrade Notes:

Press and hold any button for 3 sec. to exit Upgrade Mode. The device will automatically exit Upgrade Mode after 1 minute idle.

### Remarks:

1. Do not unplug the USB cable during the upgrade process.
2. In case of a malfunction. Long pressing any button will return to the main interface.
3. If the computer doesn't recognize the device while upgrading, try a different USB cable.
4. Please use the Mac version of SXi software in order to upgrade on a Mac computer.

### Warning Messages:

Notice	Error	Solutions
No Atomizer	Either the atomizer is not connected, or the unit has detected a problem	<ul style="list-style-type: none"> <li>Try to reinsert coil</li> <li>Change a new coil</li> </ul>
No Liquid	Anti-dry burn warning	<ul style="list-style-type: none"> <li>Refill Tank</li> <li>Adjust pump speed</li> </ul>
Low Battery!	Battery voltage is too low. (lower than 3.2V)	<ul style="list-style-type: none"> <li>Recharge device</li> </ul>
Low Resistance	The resistance of the atomizer is too low (lower than 0.1ohm)	<ul style="list-style-type: none"> <li>Change coil</li> </ul>
Short!	The unit has detected an output short	<ul style="list-style-type: none"> <li>Contact Support</li> </ul>

### Specifications:

- Chipset : SX681J
- Battery capacity: 900mAh
- Reservoir capacity: 2 ML
- Reservoir material: PETG
- Max Charge: 5V/1A
- ~60 min to full charge
- Quiescent Current <3 uA
- E-liquid pump speed : 10-60
- Device size: 87.4\*39\*17.9mm
- ADA mode supported coils: SX ADAv2

### Included in the box:

- \* 1× SX Nano device
- \* 1× SX-ADAv2 atomizer set (0.6Ω)
- \* 1× 0.6Ω Disk coil
- \* 2× Reservoir
- \* 1× USB Type C cable
- \* 1× User manual
- \* 1× Warranty card

### Features:

- Automatic fast and precise E-liquid injection Technology.
- Dry Hit protection.
- Choose Auto or Manual E-liquid Feed/Draw.
- Fresh e-liquid on every hit - E-liquid is stored separated from the heating element.
- Leak Proof - E-Liquid is securely kept in a sealed bottom compartment, eliminating any chance of leakage.
- Auto Boost e-liquid feed on longer hits.
- Fresh coil priming timer - know when a new coil is ready to vape.
- 3 Taste presets to choose from for easy tasty vape.

### Precautions:

- Opening the body of the device voids warranty.
- Do not leave the device in high temperatures or damp conditions, as this may damage the device.
- If the e-liquid has leaked into the body of the device, please allow it to dry completely. Using the device while damp may damage the electronics.
- Check the authenticity of the device by entering the security code on our official website.
- Take care not to damage the USB while charging.
- The device warranty period is 6 months.
- If you experience any problems with your device, please contact our customer service via:  
www.yihisxmini.com/contact.html

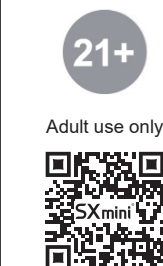

Manufactured by SXmini  
Add: Building 1, Yuanxia Road 25, Xiakeng Village, Changping Town, Dongguan City, Guangdong, P.R.China 523575  
TEL: +86 0769 83865833  
FAX: +86 0769 83865833  
www.yihisxmini.com  
Designed by SXmini in China  
Made in China

